

## HR02

### CERNIERA REGOLABILE 4P D16 H41+41 L45 ADJUSTABLE HINGE 4P D16 H41+41 L45

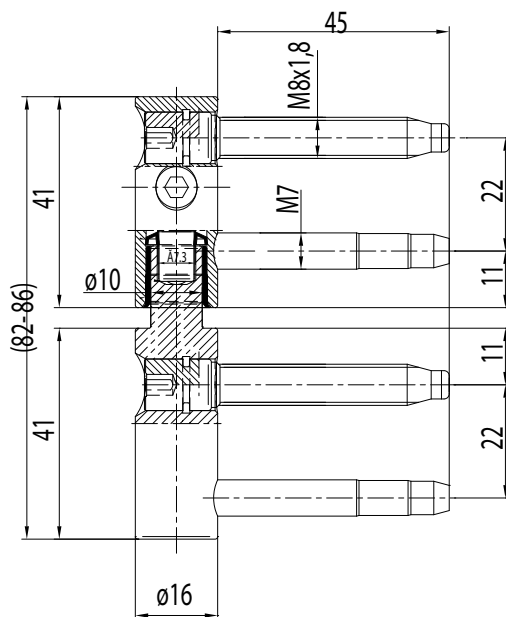
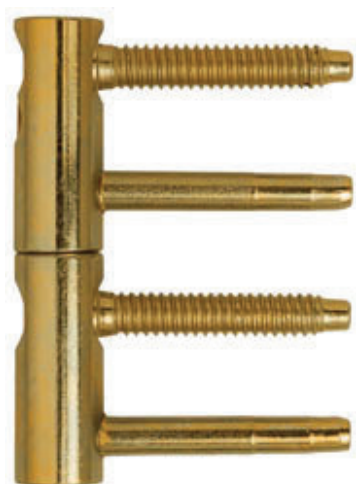

#### CARATTERISTICHE / FEATURES

Cerniere a vite a 4 perni registrabili in 3 dimensioni (verticale, orizzontale, in pressione) diametro 16 mm per porte e finestre in legno per applicazione a battente e a filo.

Four pins screw-in adjustable in 3 dimensions (vertical, horizontal, in pressure) hinges diameter 16 mm for timber doors and windows for rebated or flush application.

PORTATA MAX LOAD	Ø CORPO Ø BODY.	H. CORPO L. GAMBI BODY H - STEMS L	Ø GAMBI Ø STEMS	REGOLABILE ADJUSTABLE	MATERIALE MATERIAL
68 Kg 3 cerniere 3 hinges	16 mm	41 mm 45 mm	M8 - 7 mm	Si, in altezza Yes, in height Si, in profondità Yes in depth	Acciaio Steel

#### FINITURE / FINISHINGS

Zincato Bianco  
White Zinc

Zinco Tropical  
Tropical Zinc